

# TOWNSHIP 2 N., RANGE 9 W.W.M. TILLAMOOK COUNTY ORE.

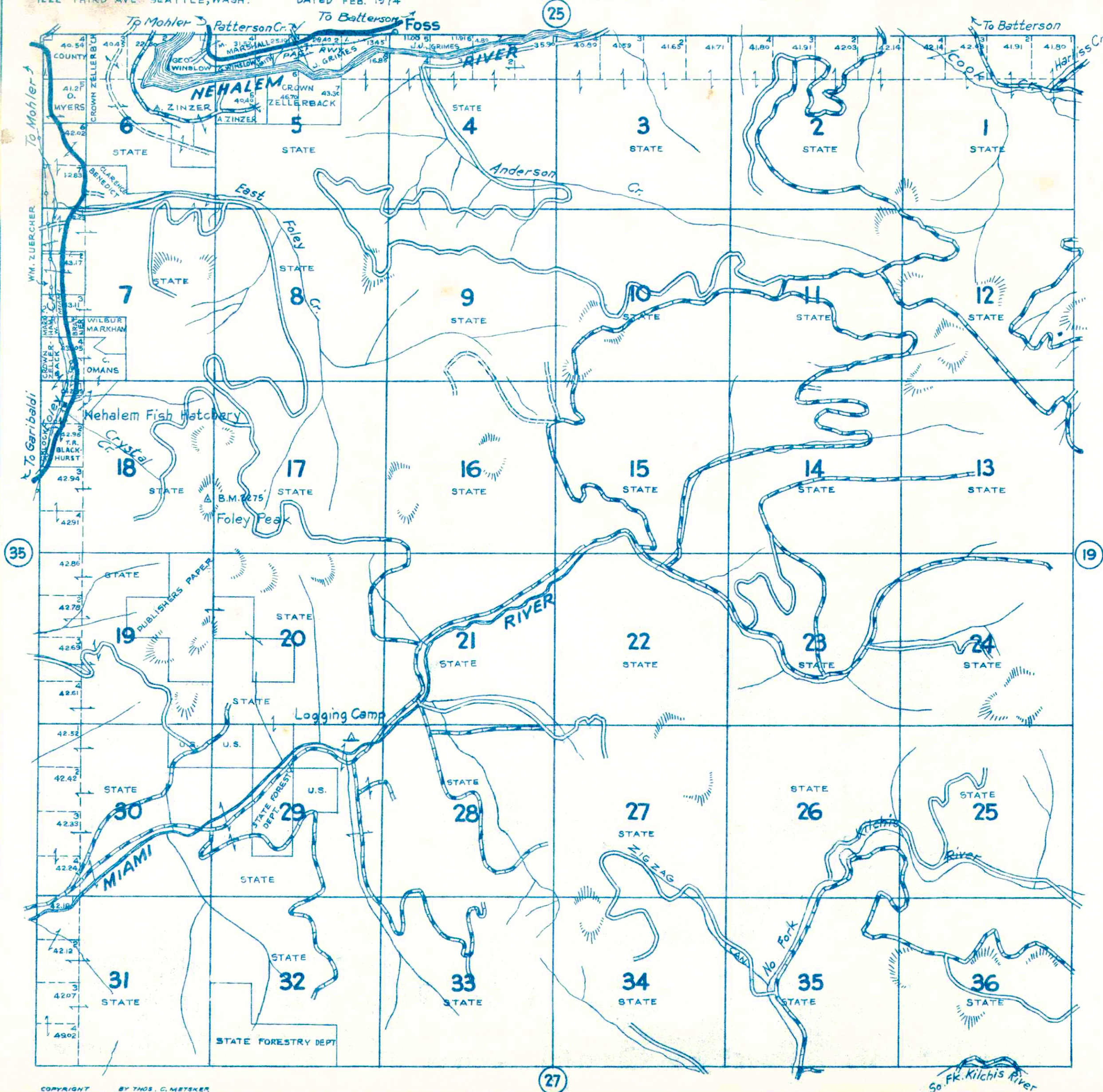

- SMALL TRACTS**
- 1. W.M. EMIGH SEC. 5
  - 2. ED TOMLINSON SEC. 6
  - 3. PUBLISHERS PAPER SEC. 7
  - 4. RICHARD ATHERTON
  - 5. E. KLOCK

Reproduction in whole or part for personal use or resale is prohibited by law.

- LEGEND**
- STATE HWY. 6 U.S. HWY. 101
  - PAVED HIGHWAYS
  - IMPROVED DIRT ROADS
  - DIRT ROADS
  - INFERIOR ROADS
  - RAILROADS
  - TRAILS
  - INTERMITTENT CREEKS
  - NAT'L FOREST BDRYS XXXXXX
  - ELEC. PWR. TRANS. LINES